

# North Metro Corridor DEIS/BE

## Level 3

## Station Option Concepts



## Denver Stations

## Swansea / Elyria Station Options



## TABLE OF CONTENTS

Swansea / Elyria Option 1 Concept.....	2
Swansea / Elyria Option 2 Concept.....	3
Swansea / Elyria Option 3 Concept.....	4

## Swansea / Elyria Option 1 Concept

**DESCRIPTON:** The North Metro project team created this concept from public and agency input. It incorporates a location suggested by the North Metro Major Investment Study 2001. It is located on the southeast corner of 48<sup>th</sup> Avenue and Josephine Street, and features small parking lots west of track and east of track.

2015 Parking Demand: Low. Station likely to be primarily walk-up. Proposed Parking: Small – up 22 off-street parking spaces.



## Swansea / Elyria Option 2 Concept

**DESCRIPTON:** The North Metro project team created this concept from public and agency input. It incorporates a location suggested by the North Metro Major Investment Study 2001, and also incorporates RTD FasTracks TOD concepts. It features a small parking lot west of track, and either no parking, or shared parking east of track, per request from neighborhood groups. It is located on the southeast corner of 48<sup>th</sup> Avenue and Josephine Street.

2015 Parking Demand: Low. Station likely to be primarily walk-up. Proposed Parking: No parking – except possible shared parking with church. Design could accommodate up to 12 off-street parking spaces.

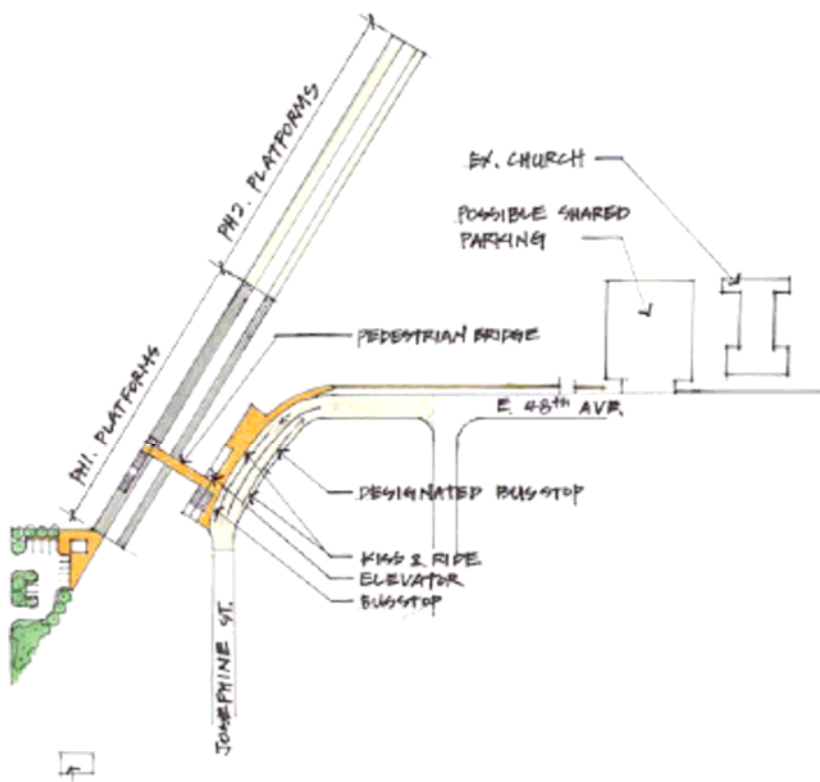

## Swansea / Elyria Option 3 Concept

**DESCRIPTON:** The North Metro project team created this concept from public and agency input. It is located on the northeast corner of 51<sup>st</sup> Avenue and Fillmore Street.

2015 Parking Demand: Low. Station likely to be primarily walk-up. Proposed Parking: Design could accommodate up to 30 off-street parking spaces.

