

North Metro Corridor DEIS/BE

Level 3

Station Option Concepts



Thornton Stations

144th Avenue Station Options



TABLE OF CONTENTS

144 th Option 1 Concept.....	2
144 th Option 2 Concept.....	3
144 th Option 3 Concept.....	4
144 th Option 5 Concept.....	5
144 th Option 6 Concept.....	6
144 th Option 10 – No Station	7
144 th Option 11 Concept.....	8

144th Option 1 Concept

DESCRIPTON: The North Metro project team created this concept from public and agency input. It features a neighborhood parking station on west side of tracks and access from York Street and 144th Avenue.

2015 Parking Demand: Low (up to 250 spaces). Proposed Parking Lot: Small (up to 44 spaces).

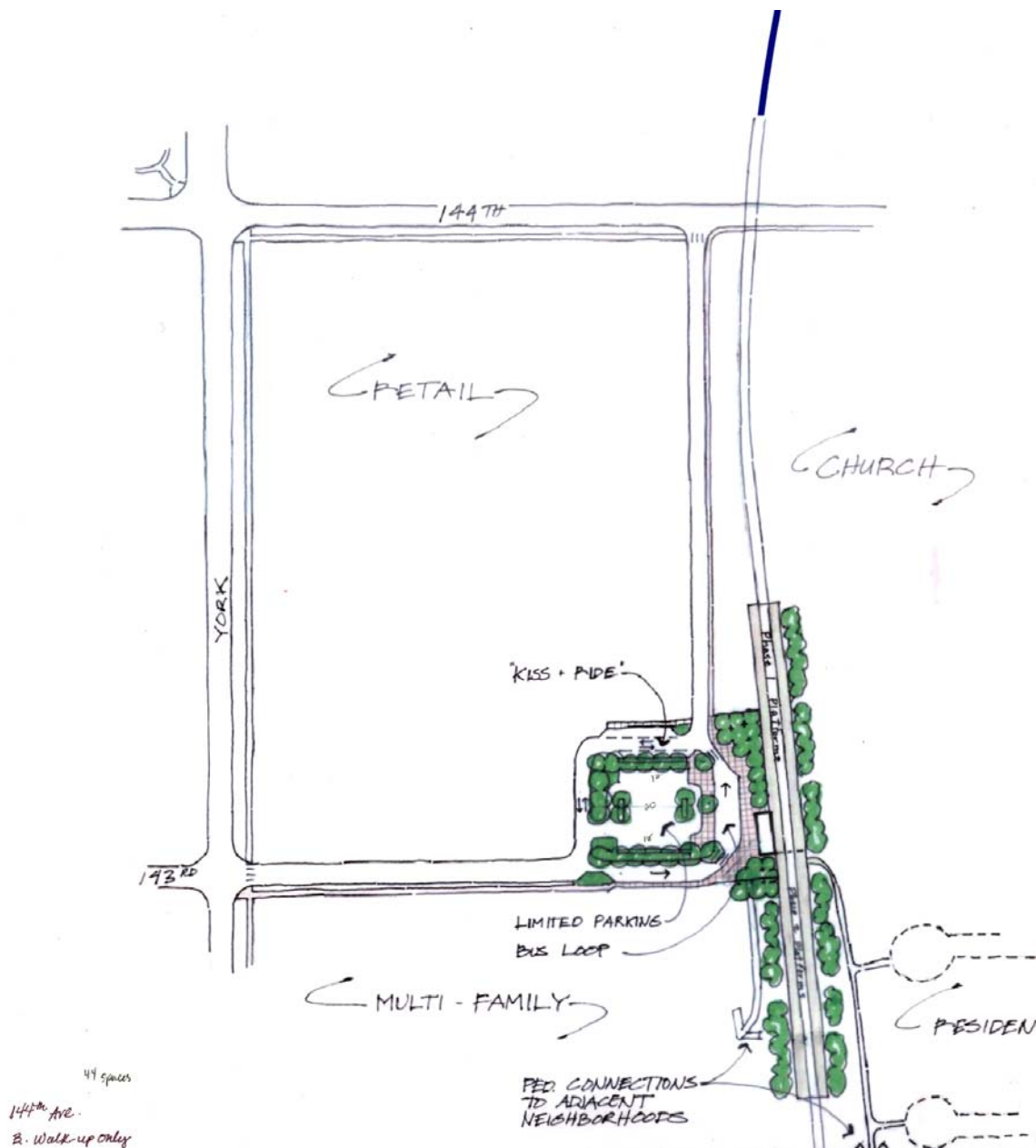

144th Option 2 Concept

DESCRIPTON: The North Metro project team created this concept from public and agency input. It features a small parking lot on west side of tracks and access from York Street.

2015 Parking Demand: Low (up to 250 spaces). Proposed Parking Lot: Small (up to 131 spaces).

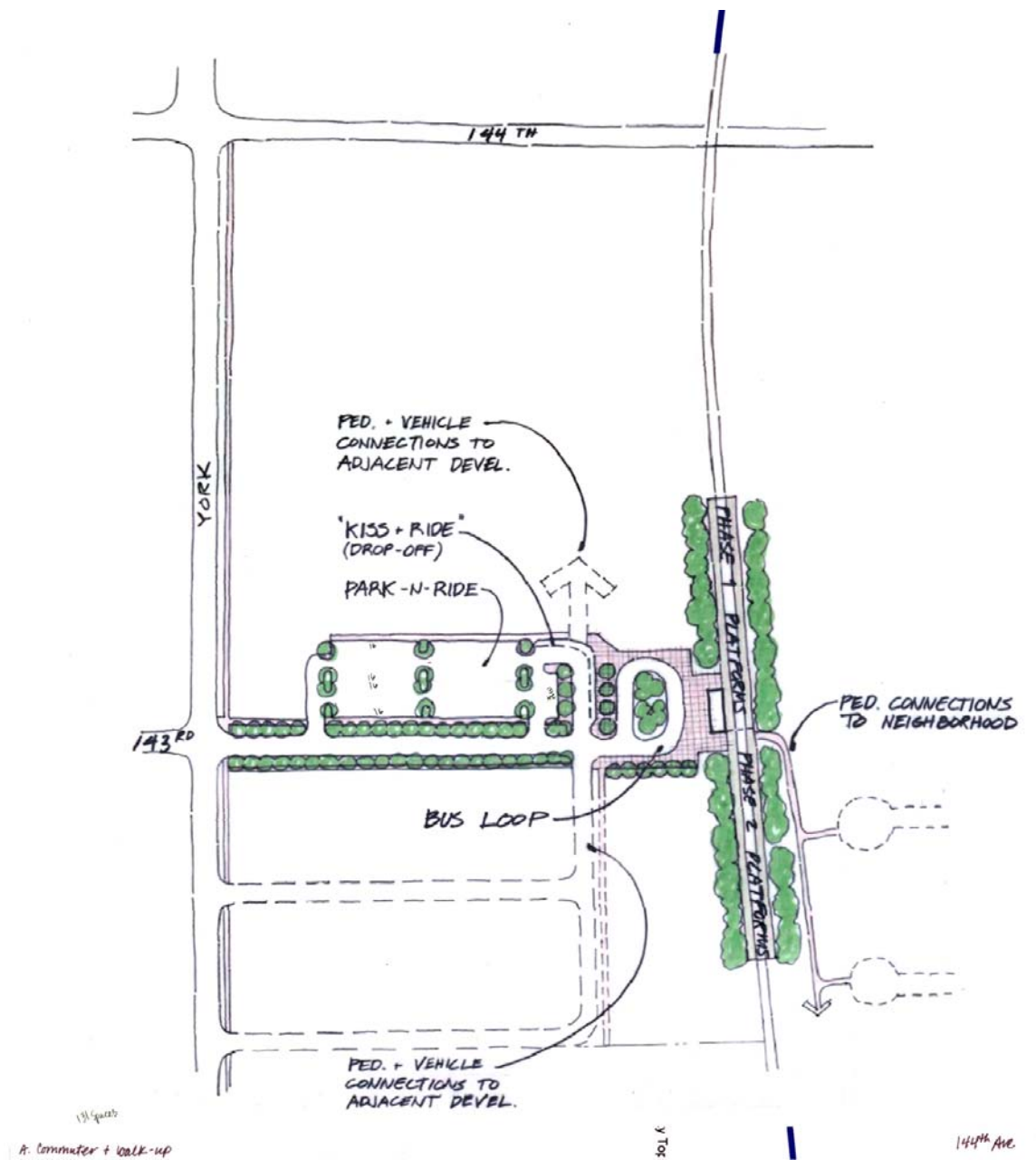

144th Option 3 Concept

DESCRIPTON: The North Metro project team created this concept from public and agency input. It incorporates a general plan from the Three Corridor Study 2005. It features a medium parking lot on west side of tracks and access from 144th Avenue.

2015 Parking Demand: Low (up to 250 spaces). Proposed Parking Lot: Medium (240 spaces).

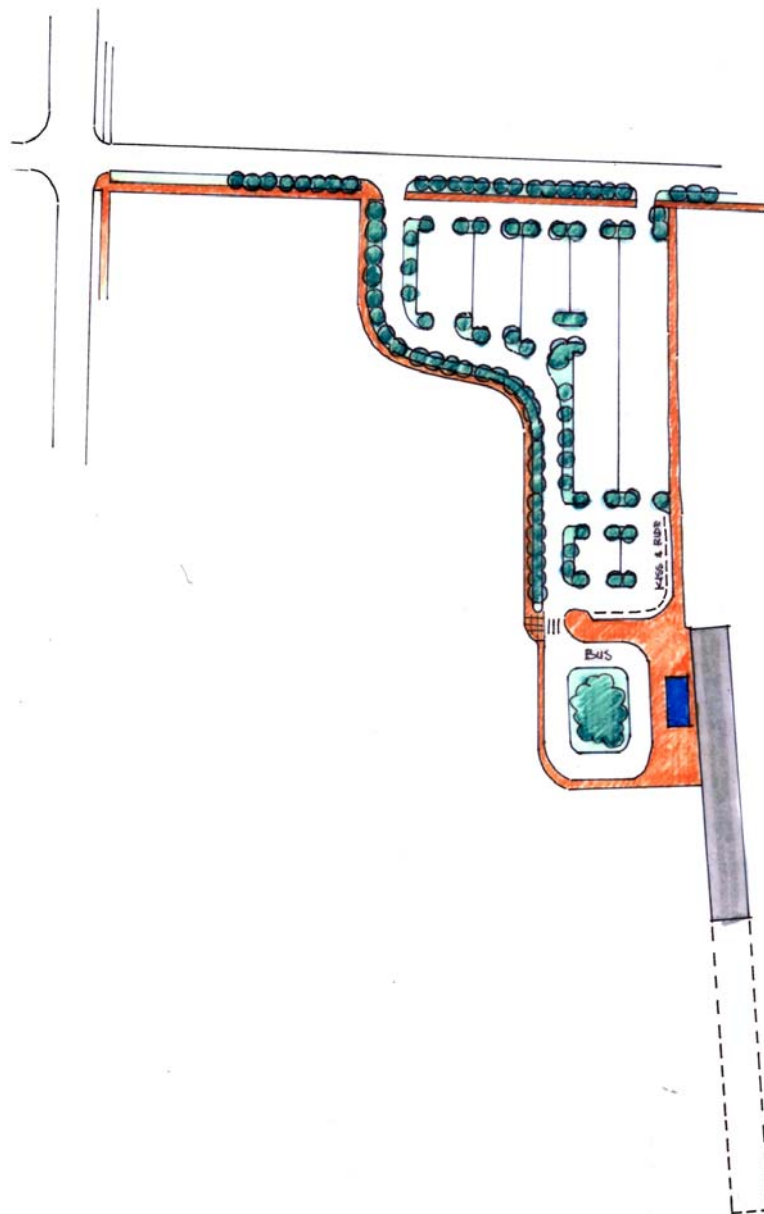

144th Option 5 Concept

DESCRIPTON: The North Metro project team created this concept with ideas from the RTD FasTracks TOD concepts also featured in 144th Option 4 (144th Option 4 was therefore not promoted to Level 3 analysis). It features a medium parking lot on east side of tracks. It is primarily a walk-up/drop-off station on the west side with access from 144th Avenue on the east and west, and York Street on the west.

2015 Parking Demand: Low (up to 250 spaces). Proposed Parking Lot: Medium (370 spaces).

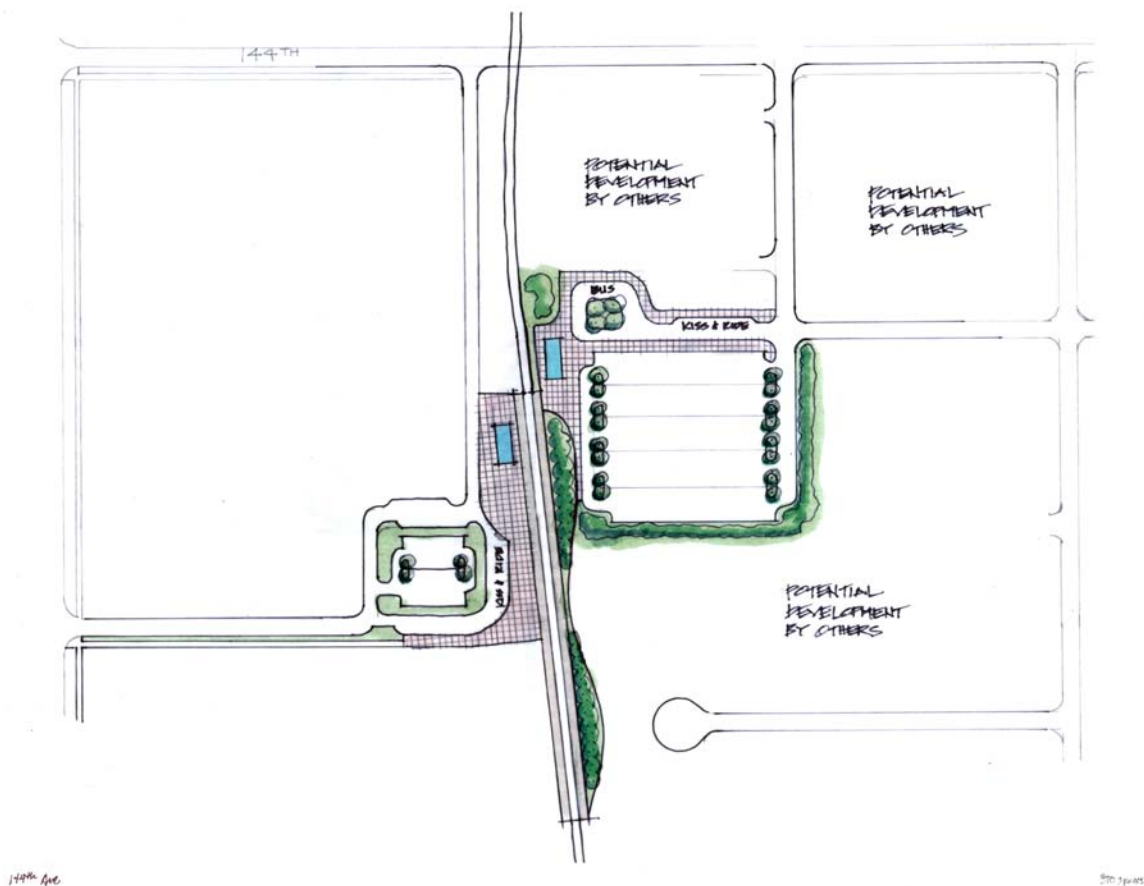

144th Option 6 Concept

DESCRIPTON: The North Metro project team created this concept from public and agency input. It incorporates a general plan from the Three Corridor Study 2005 for the west side. It features a medium parking lot on the east side of tracks, a medium parking lot on the west side, and access from 144th Avenue on east and west.

2015 Parking Demand: Low (up to 250 spaces). Proposed Parking Lot: Medium (720 spaces).

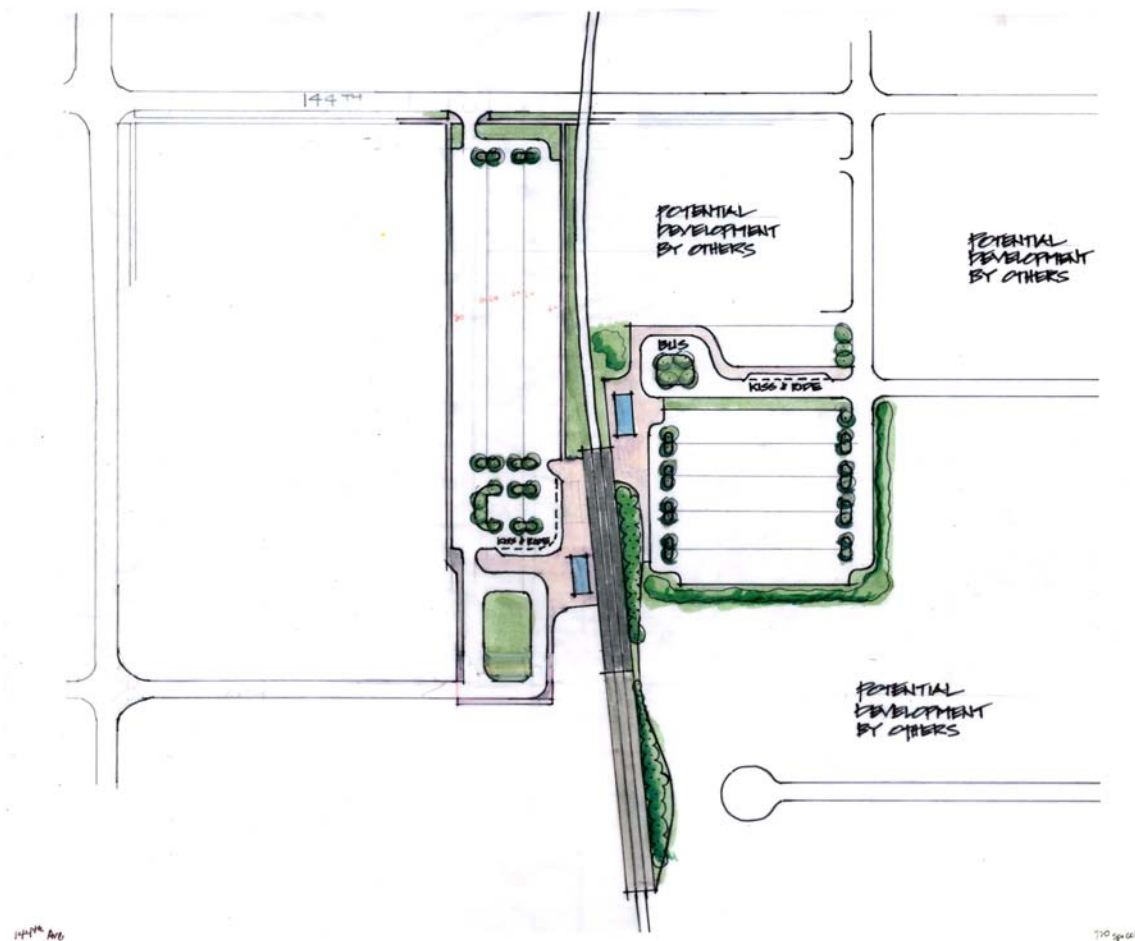

144th Option 10 – No Station

No Station, No Concept

DESCRIPTON: The neighborhood groups near the proposed 144th station site propose NO STATION.

2015 Parking Demand: Low (up to 250 spaces).

There will be basic analysis of 144th Option 10.

144th Option 11 Concept

DESCRIPTON: The neighborhood groups near the proposed 144th station site request that if there must be a station, to please provide a kiss-n-ride type of station only. Access would be from the west side off York Street and 144th Avenue.

2015 Parking Demand: Low (up to 250 spaces). Proposed Parking Lot: 0.

